

 **Sevana**  
*Your Packaging Partner.*



***Sevana's Double Chamber Vacuum Packaging Machines***

*Vacuum Packaging - Way to better and healthy food preservations.*

- Microprocessor based.
- Sensor based system for accuracy.
- Double Productivity.
- Sturdy and heavy gauge design.
- Four preset programs.
- Fully see through lid.
- User-friendly consumable replacement.
- Cycle counter.
- Oil level alarm.
- Digital Display.
- Stainless steel contact parts.
- Emergency stop button.
- Electrical protection systems.
- Initial fresh air flushing for pouch protection.
- Independent control for individual set of jaws.
- Power failure air intake system.
- Fully stainless steel option.

- We customize as per your requirement.
- Stainless steel versions are available.
- Special paint colour is available.
- 3 Gas Flushing option.

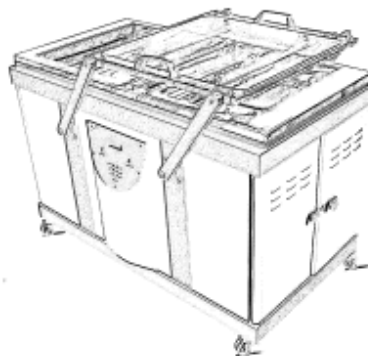

## Technical Specification

Model	Chamber Dimension			Sealing			N	Power		Dimensions			Weight Kg
	C	D	H1	F	W	E		V	W	L	B1	H	
QS400 V TWIN	520	456	65/100	400	3	350	3	415	1500	1232	742	845/880	210
QS500V TWIN	620	456	65/100	500	3	350	3	240	1900	1232	842	845/880	250

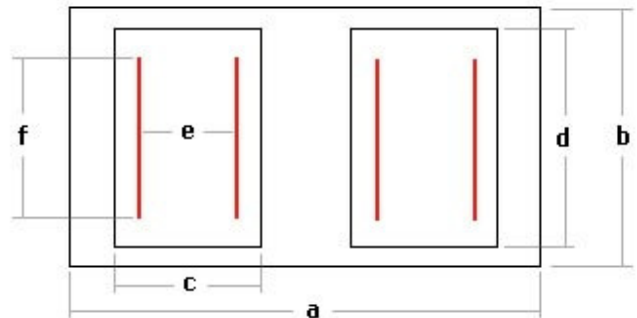
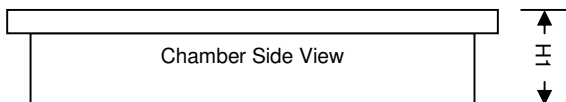

### Sevana Electrical Appliances Pvt Ltd

Kizhakkambalam P.O., Ernakulam Dist  
Kerala, India-683562

Phone: +91-484-2680780(8 Lines)

Fax: +91-484-2680680

Web: [www.sevana.Com](http://www.sevana.Com)

Email: [mail@sevana.Com](mailto:mail@sevana.Com)

**60 Service Centres**  
**12 Offices**  
**600 Channel Partners**

To locate our channel partner near you, contact us.

An ISO 9001:2000 Certified Company